

PF Wire Series
Sub-Miniature Pushbutton Switches



MATERIALS
CAP: Polyamide 6/6.
PLUNGER: PFS6:PC / PFS7:Polyamide 6/6.
RUBBER: Silicone.
BUSHING: Polyamide 6/6.
CASE: Diallyl phthalate (DAP)(UL94v-0).
TERMINAL/CONTACTS:Gold over silver plated.
Multi-wire lead AWG20,section 0.6mm²,UL approved

SPECIFICATION
MAX. CURRENT/VOLTAGE RATING WITH RESISTIVE LOAD :
400mA 32VAC - 200 mA 50VDC - 125 mA 125VAC.
INITIAL CONTACT RESISTANCE : 100mΩmax.
INSULATION RESISTANCE : 1GΩmin.at 500VDC.
DIELECTRIC STRENGTH : 1,500 VAC rms.
ELECTRICAL LIFE AT FULL LOAD : 500,000 cycles.
OPERATING TEMPERATURE : -30°C to 85°C.
PANEL THICKNESS : 1.5 mm (.059) min. -4 mm (.157) max.
TOTAL TRAVEL : 1.5 mm(.059)
OPERATING FORCE : 3N-6N
CONTACT BOUNCE : 10 ms.
MECHANICAL LIFE : 1,000,000 cycles.
TORQUE : 0.5 Nm max.applied to nut
DEGREE OF PROTECTITON: IP68
MANUAL SOLDERING:
Use soldering iron of 30 watts, controlled at 350°C approximately
5 seconds while applying solder.
WAVE SOLDERING:
Recommended Soldering Temperature: 260 ± 5°C
Ambient temperature of the soldered Surface of PC board.110°C Max.
Duration of Solder Immersion: Max 5 sec.(PCB is 1.6mm in thickness)

IP 68 for the whole series:
Protected against the effects
of immersion up to 1 m water(60min)

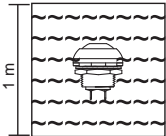

HOW TO ORDER

MODEL NO. BUSHING CAP COLOR TERMINATIONS CONTACT MATERIAL SEAL RoHS SOLDERING ADDITIONAL HARDWARE LED COLOR WIRE

Model NO.
PFS6 SP OFF-(ON)
PFS7 SP ON-(OFF) (Without LED)

Bushing
B2 Threaded bushing

Cap color
0 Flat,Matte
A Round,Bright(Non-LED)
G High,Bright(Non-LED)
* Only flat cap available with LED.

Terminations
M1 Solder lug(STD)

Contact material
C Gold over silver

Seal
A Sealed (STD)

RoHS soldering
S Rohs & Lead Free

Additional hardware
05 Additional hardware
* See page 145

LED Color
ITEM NO COLOR
L00 Without LED
L01 White
L03 Red
L05 Yellow
L06 Green
L07 Blue

Wire
S001 500mm leads cylinder(PFS6 only)
S002 90mm leads cylinder,stripping wire(PFS6 only)
S003 100mm leads cylinder(PFS6 only)
Y001 500mm leads heat shrink
Y002 90mm leads heat shrink,stripping wire
Y003 100mm leads heat shrink





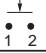
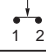
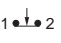

Table with 3 columns: CAP COLOR, ITEM NO., and sub-items (Matte, Bright, Bright). Rows include White, Black (Std), Red (Std), Yellow, Green, and Blue.

* Besides standard color, other colors need to check stocks available.

EXAMPLE:
PFS6B202MM1CAS05L03-S001

Wire code

SWITCH FUNCTION

NO. POLES	MODEL NO.	SWITCH FUNCTION		CONNECTED TERMINALS / SCHEMATIC	
		POS.1	POS.2	POS.1	POS.2
					
SP	PFS6	OFF	(ON)	OPEN 	COLSE 
SP	PFS7	ON	(OFF)	CLOSE 	OPEN 

()=MOMENTARY

BUSHING

B2

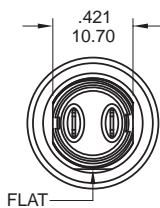
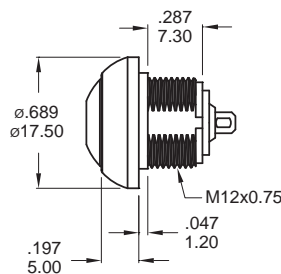

PANEL CUT-OUT

THICKNESS: 1.5 mm ~ 4.0 mm

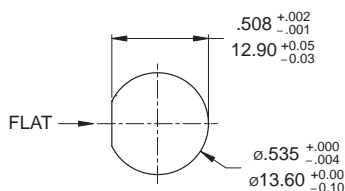

CAP OPTIONS

FLAT

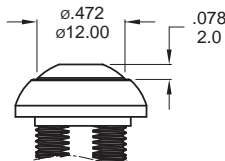

ROUND Non-LED

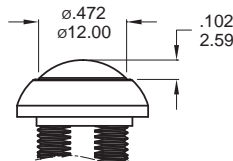

HIGH Non-LED

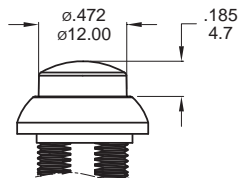

WIRE OPTIONS

SXXX Only for model type PFS6

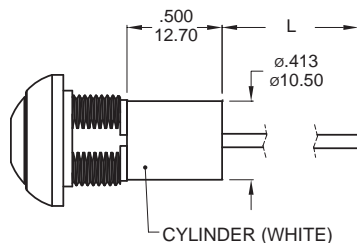

YXXX

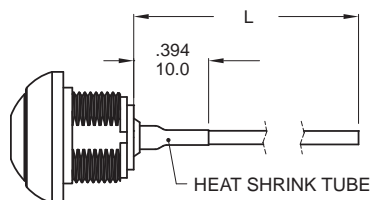

WIRE LENGTH

CODE	DIM "L"
S001	500±10(19.7±.394)
S002 *	90±5(3.54±.197)
S003	100±5(3.94±.197)
Y001	500±10(19.7±.394)
Y002 *	90±5(3.54±.197)
Y003	100±5(3.94±.197)

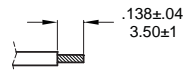

* Stripping wire for code S002 and Y002.

※ Multi-wire lead AWG20, section 0.6mm², UL approved.

Non-LED

DESCRIPTION	WIRE COLOR
TERMINAL 1	BLACK
TERMINAL 2	BLACK

With LED

DESCRIPTION	WIRE COLOR
TERMINAL 1	BLACK
TERMINAL 2	BLACK
LED+	RED
LED-	GREEN